

PROTECTA® FR PUTTY PAD

INSTALLATION INSTRUCTIONS



GENERAL PRODUCT DESCRIPTION

Protecta® FR Putty Pads are an easy to apply fire and sound rated sealant supplied as a non-setting putty. The pad is hand workable, re-useable and re-serviceable due to its non-setting properties.

When electrical sockets and switches are installed in dry lining partitions, the original fire rating of the partition is compromised. Fitting Protecta FR Putty Pads will reinstate the fire rating of the partition for up to two hours (depending on the partition fire rating) and prevent the passage of smoke and flames in a fire, and sound and air movement during service life, through the electrical socket, into the cavity.

Protecta FR Putty Pads are shaped for use on both single and double electrical sockets installations in dry lining walls. The pads are supplied in a cross shape for internal installation in a socket and in a rectangular shape for application on the rear of the socket.

FIRE CLASSIFICATION - TABLE

Socket Box	Installation	Class
FLEXIBLE WALL CONSTRUCTIONS ≥ 100MM		
UK standard socket boxes up to 135mm wide x 75mm high x 50mm deep	Interior of box fully lined with pad	EI 60
Schneider IMT 36026 connection box, 72mm wide x 90mm high x 50mm deep	Fitted lining the back of the back box	E 60 EI 45
ELKO 4189 1223720 connection box, 72mm wide x 90mm high x 58mm deep	Interior of box fully lined with pad	EI 90
ELKO 5421 123740 connection box, 73mm wide x 73mm high x 55mm deep		
FLEXIBLE WALL CONSTRUCTIONS ≥ 120MM		
UK standard socket boxes up to 135mm wide x 75mm high x 50mm deep	Interior of box fully lined with pad	EI 120

GENERAL GUIDE

Minimum separations and limitations: Socket boxes can be fitted back to back or side by side – one fitted to each face. Minimum separation between socket boxes on one side of the wall should be at least 30 mm.

Supporting constructions: Flexible walls must have a minimum thickness of 100 mm and comprise steel studs or timber studs*) lined on both faces with minimum 2 layers of 12.5 mm thick boards. The supporting construction must be classified in accordance with EN 13501-2 for the required fire resistance period.

*) Timber studs: no part of the penetration seal may be closer than 100 mm to a stud, and minimum 100 mm of insulation of class A1 or A2 according to EN 13501-1 must be provided within the cavity between the penetration seal and the stud.



INSTALLATION

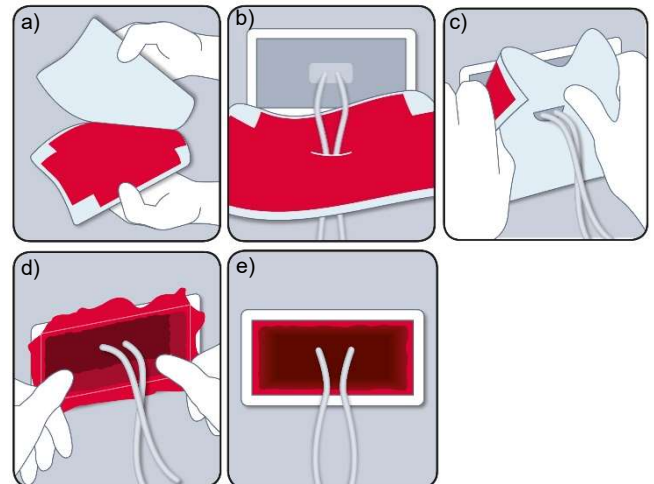

1. Wall boxes should be installed according to the Manufacturer's Instructions.
2. Before installing Protecta® FR Putty Pad ensure that the surfaces are clean and sound, free from dirt, grease and other contamination.
3. Remove the backing paper from one side of the pad.
4. **Internal fitted:** insert the pad into the socket back box so that the pad completely covers the back and sides. Make a slit to allow the wires to pass through the pad. Trim off any excess material and proceed as normal installation.
Back face fitted: place the pad over the socket back box so that the pad completely covers the back and overlaps onto the dry lining partition. It may or may not be necessary to make a slit in the pad for the wires depending on the installation.
5. Remove the last backing paper.

TEST STANDARDS

This Installation Instructions and the Technical Data Sheet are based on the product's European Technical Assessment issued in accordance with regulation (EU) No 305/2011 on the basis of EAD 350454-00-1104, September 2017, tested to EN 1366-3 & -12 in conjunction with EN 1363-1. The product hold the following approval marks; CE-mark for Europe, UL-EU Certificate Internationally, UAE Certificate of Compliance & AS assessment for Australia and New Zealand.